

Category	Battery Powered Rope Ascender
Length (L)	28,6 cm
Width (W)	34,3 cm
Height (H)	29,8 cm
Weight	9,15 kg
Construction	Aluminum 7075
Finish	Powder Coat Black
Operating Temperature Range	-4 °F – 120 °F (-20°C to +49°C)
Ingress Protection (IP)	IP54
Battery Type	48 VDC Lithium Ion Rechargeable
Battery Life Ascent	91 m of rope @ 181 kg 183 m of rope @ 91 kg
Battery Re-Charge Time	Approximately 2 hours
Rope Type	11,5 – 13 mm Kernmantle Static Rope EN1891
Rope Loading	End Feed
Ascent Speed	Variable (0,15 bis 0,46 m/sek.)
Descent Method	Gravity Feed with manual brake
Descent Speed	0,85 m/sek. max @ 181 kg
Secondary Safety	Secondary Lock Out Feature (Hands Free)
Max Working Load	181 kg
Product Certifications	CE Certified & ANSI Certified
Reverse Functionality	For Angled Ascents, winching applications, removing rope from the system.

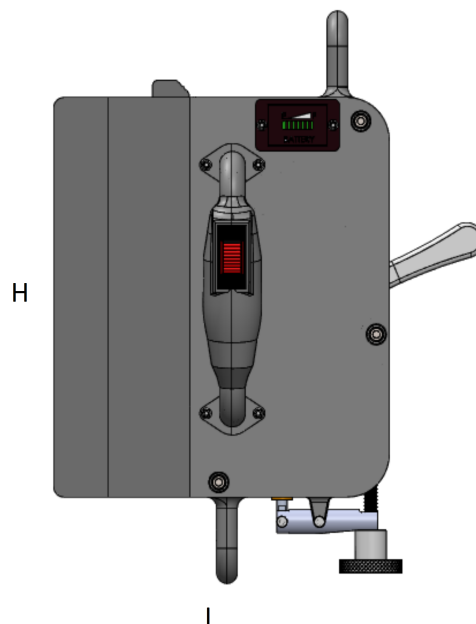

W

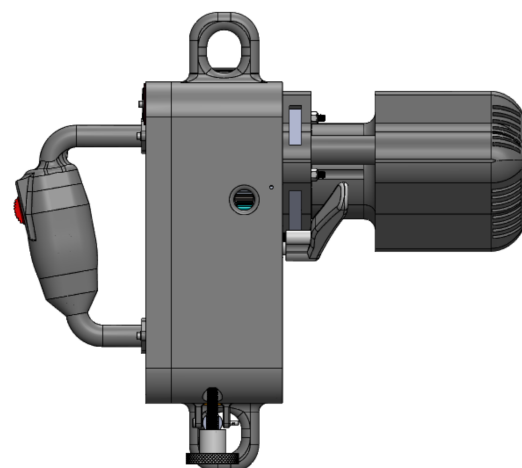

## Features

- Lightweight & portable
- Rugged and durable construction
- 400 lbs. (181 kg) safe working load
- Thumbwheel trigger for variable speed control
- Secondary Lock safety feature for hands free work
- Hot swappable battery pack for continuous use
- Integrates with existing climbing technology
- Works as both a winch and ascender

## Applications

- Tower/Telecommunication
- Power Utility
- Wind Turbine
- Arbor care
- Building Maintenance
- Construction
- Rescue, Fire, Police